

Noise is a health risk. For this reason, noise reduction is an important task in the field of working protection in industrial production

Silencers are mounted in the air outlet opening, for example pneumatic systems, to reduce the sound pressure to an acceptable level.

Technical data:

Material: Polyethylene (PE)
Operating pressure: Max. 6 bar
Temperature range: 5 °C to 80 °C **Attention:**

The air flowing through the silencer is cooled down; at temperatures below zero, the moisture in the air can freeze at temperatures below zero, the moisture in the air can freeze, causing the pores of the silencer to close up.

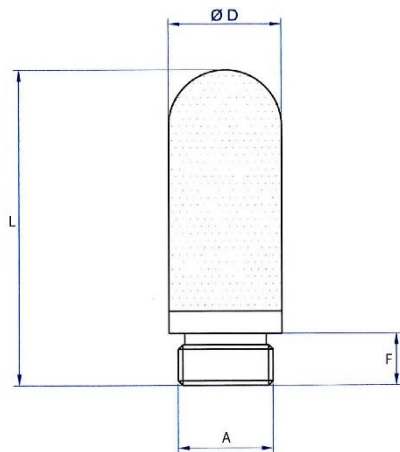

566-2

Silencer made of polyethylene						
Art. No.	Type No.	Thread A	Pore size µm	Ø D mm	F mm	L mm
113320	566-0	M5	15 to 35	7.0	5.0	25.0
113321	566-1	G 1/8	40 to 50	13.0	7.0	32.0
113322	566-2	G 1/4	40 to 50	17.0	8.0	39.0
101242	566-3	G 3/8	40 to 50	25.0	11.0	65.0
113323	566-4	G 1/2	40 to 50	25.0	11.5	70.0
113324	566-5	G 3/4	40 to 50	37.0	15.5	138.0
113325	566-6	G 1	40 to 50	48.0	19.5	158.0

Sound level

Art. No.	Type No.	Sound level at 6 bar
113320	566-0	---
113321	566-1	79 - 80 dB
113322	566-2	83 dB
101242	566-3	92 dB
113323	566-4	92 dB
113324	566-5	96 dB
113325	566-6	79 dB

Flow rates

Art. No.	Type No.	Flow rate at 6 bar, outlet 5 bar, $\Delta p = 1$ bar
113320	566-0	---
113321	566-1	460 l/min
113322	566-2	520 l/min
101242	566-3	880 l/min
113323	566-4	470 l/min
113324	566-5	590 l/min
113325	566-6	580 l/min

- The use of silencers does not automatically reduce exhaust noise to a safe level.
The need for other noise-reducing measures, such as hearing protection, must be assessed as well.
- Uses and applications are the responsibility of the user. However, it is necessary to carry out appropriate tests before use in order to convince yourself of the desired function under the respective conditions.
All further claims, in particular liability for consequential damages, are excluded in principle.